

Equipment Selection

1. F&P AA451 optiflow oxygen kit
2. Armstrong pharma HME filter
3. Small quantity of sterile water



STEP 1

Push down on the base of the humidifier and slide the water chamber onto it. The chamber and tubing should both lock into place

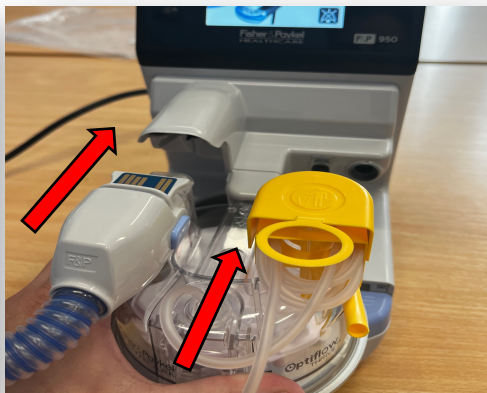

Step 2

Pull the ring tab on the yellow plastic cover to release the water tubing and open the slot for the short tubing to attach to the humidifier



Step 3

Attach the short tubing to the humidifier. Attach the HME to the other end and connect this into the inspiratory port of the Hamilton (top port)



Step 4

Pour a small quantity of sterile water into the water reservoir (approx. 100ml). Close lid and hang on IV pole.



Nasal Cannula selection

Select & connect appropriate size HFNC cannula based on best fit/flow required. Optiflow junior prongs fit into the F&P tubing. Optiflow+ prongs fit over the tubing.

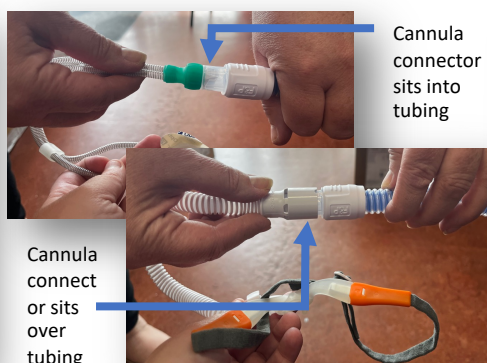

Hamilton set up

Turn on the Hamilton. Set weight. Mode set up: Select Adult/Ped for all patients. In "Modes", select HiFlow O2. Set desired flow & FiO2. Turn on humidifier – will auto recognise Optiflow mode

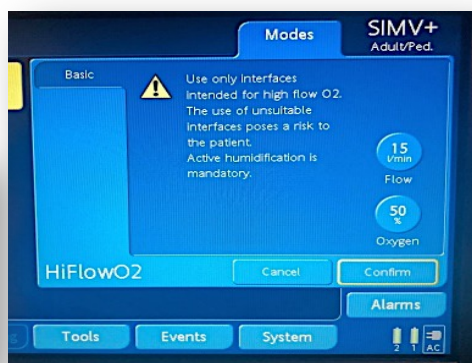

O2 consumption calculation

Complete O2 calculation once high flow is established for >5mins. **1.**Select 'system' on bottom of main screen. **2.** O₂ consumption shown on left hand side in L/min. Enter this in O₂ calc on website.

